



SLC4 & LP Series

Compact Type 4 Safety Light Screens

- Small profile for tight spaces
- Basic and full-featured models
- Highly visible alignment and diagnostic indicators
- Available in two resolutions for finger or hand detection
- Lengths from 160 to 1250 mm
- End-to-end sensing design (no-blind zone)



Banner's Line of Compact Light Screens

SLC4

- 2 meter range
- 14 and 24 mm resolution
- IP65 rated
- Defined areas from 160 to 320 mm in 80 mm increments
- Basic functionality with auto start/restart (trip output)
- Integral 300 mm M12 QD Pigtail included, brackets ordered separately

Available in Two Resolutions

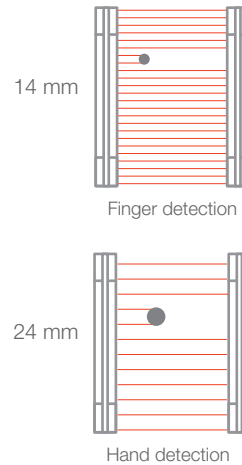

IP65 polycarbonate enclosure

Sturdy interior aluminum housing



End-to-end sensing design
(no blind zone)

Bi color red/green status indicator
shows if power is applied, and if
safety outputs are ON or OFF

Low-profile compact
package for smaller
production machines

Intuitive bi-color red/green
alignment and blocked zone
indicator lights

Threaded inserts for
end-mount brackets



LP Basic

- 4 meter range
- 14 and 25 mm resolution
- IP54 rated
- Defined areas from 270 to 690 mm in 140 mm increments
- Basic functionality auto start/restart (trip output)
- "RD" M12 pigtail and brackets ordered separately

LP

- 7 meter range
- 14 and 25 mm resolution
- IP65 rated
- Defined areas from 270 to 1250 mm in 140 mm increments
- Auto (trip output) or Manual (latch output) start/restart
- Standard brackets included
- External Device Monitoring (EDM), scan codes, aux output, reduced resolution, and fixed blanking
- Cascading, ESD-Safe and integral muting models available

Cascade Capable

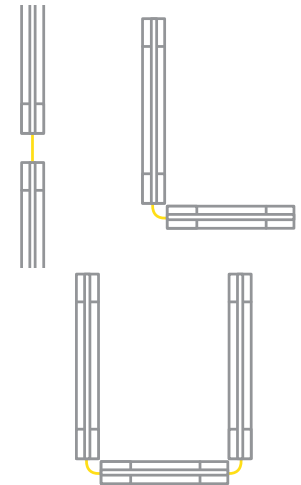

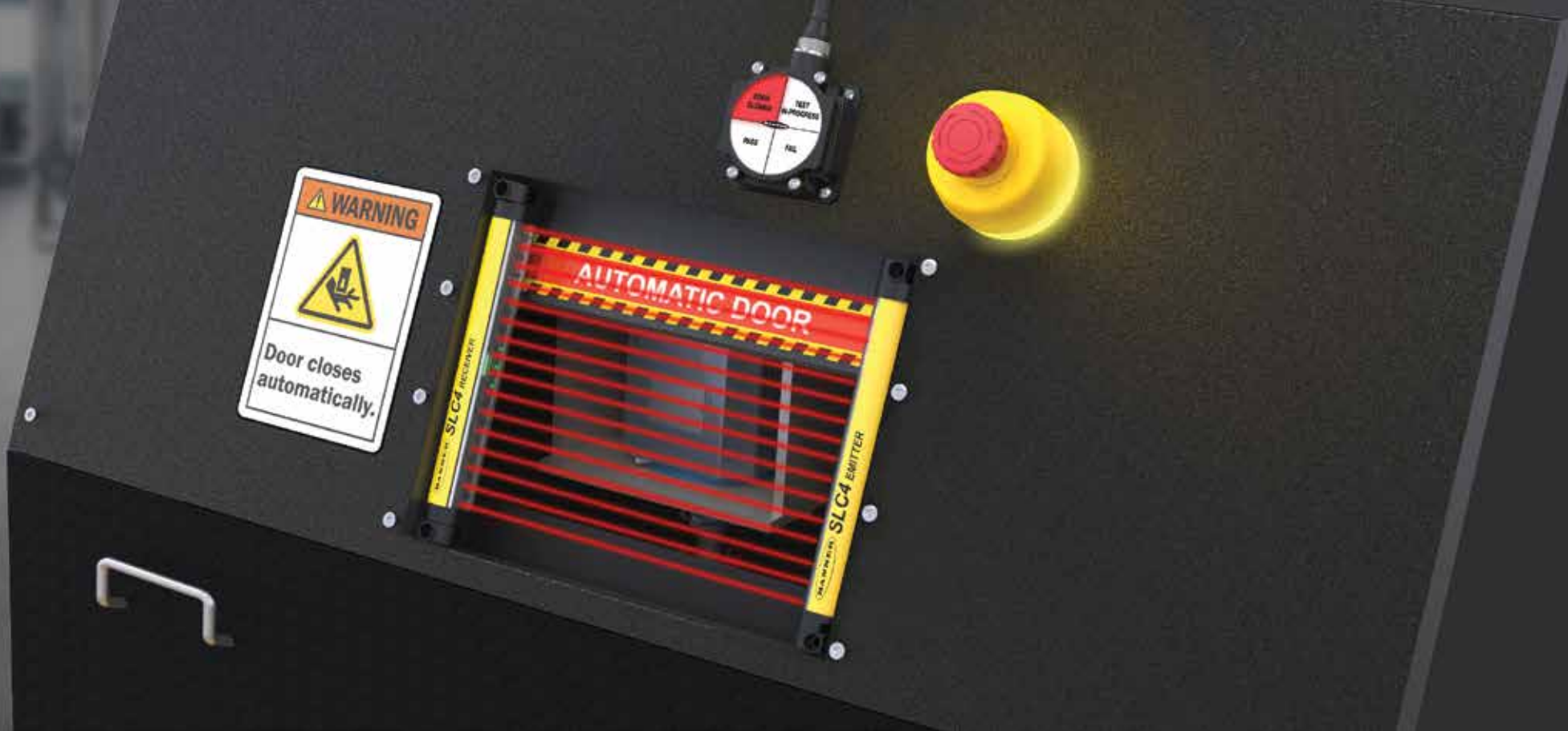

Challenge

- Protect small machine openings without restricting operator's normal motion
- Simple mounting and machine integration
- Resist damage from contact with parts being loaded/unloaded

Solution

- Compact 14 mm resolution for finger protection in lengths as short as 160 mm
- Versatile end brackets allow for simple mounting in tight spaces
- Tough polycarbonate shell with sturdy aluminum internal housing



SLC4 Models



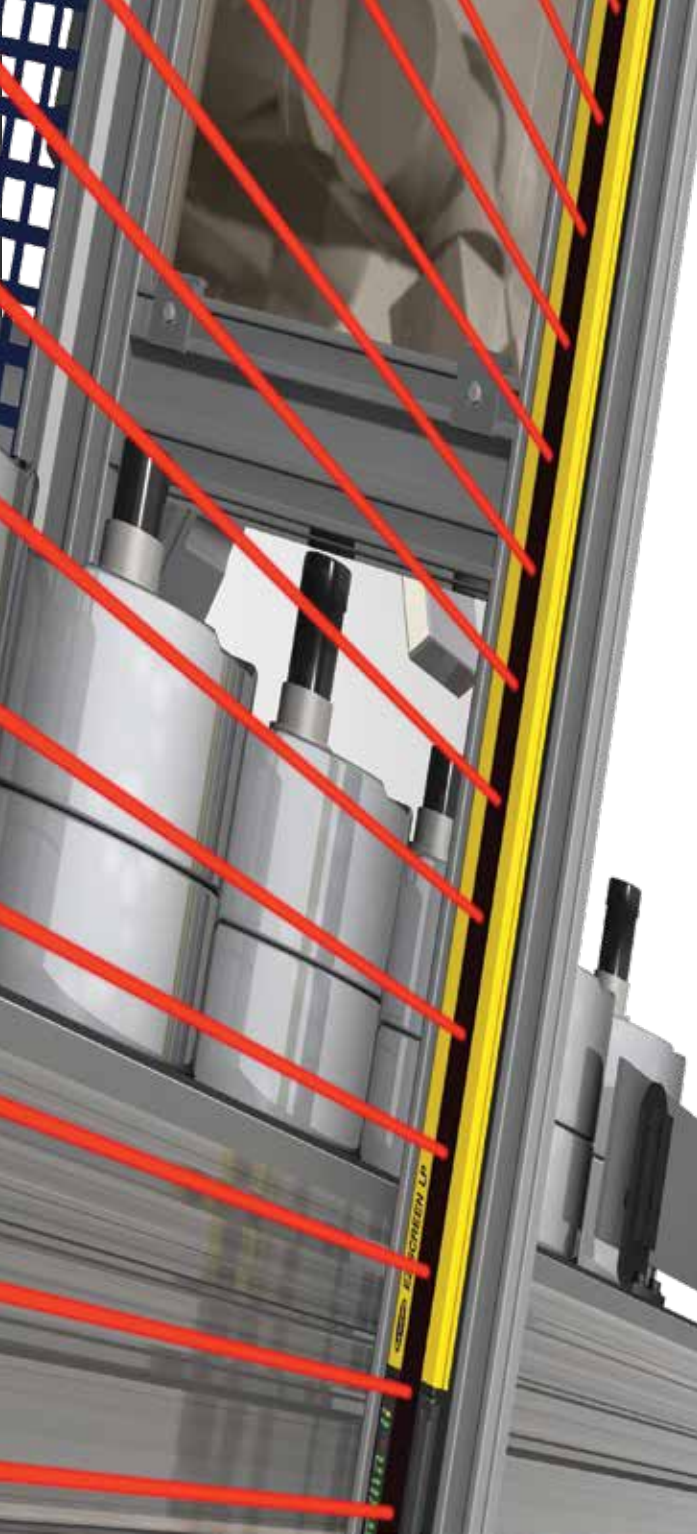

LP Basic Models

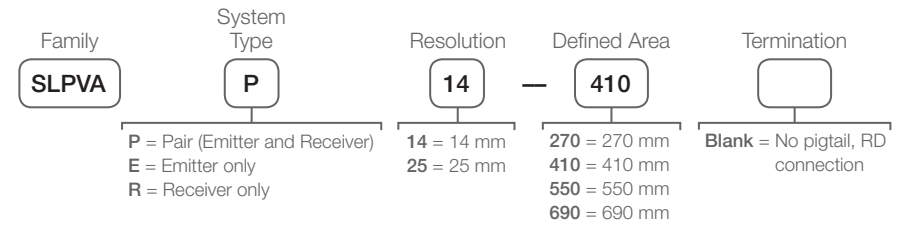

"RD" to M12 Pigtail
Euro-Style M12 Male QD to LP Custom "RD" Connector

DELPE-51D (5-pin) 0.3 m (1 ft)
DELPE-81D (8-pin) 0.3 m (1 ft)

LP Models

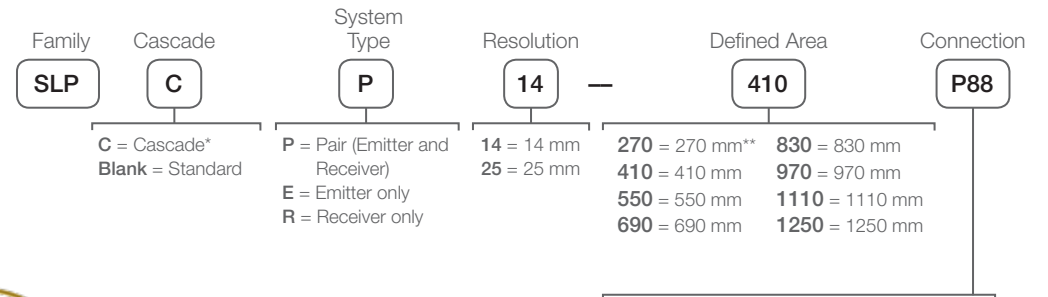
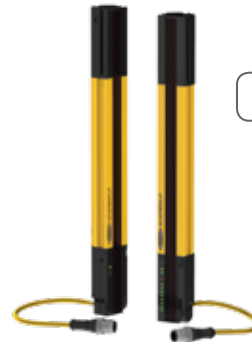

P8 = 300 mm pigtail, 8-Pin M12 QD (individual Emitter or Receiver models)
P88 = 300 mm pigtail, 8-Pin M12 QD (on BOTH Emitter and Receiver models)
Blank = no pigtail, RD connection (for RDLS-8..D or RDLS-5..D cordset)

* 8-pin Connection required for cascade models and to enable EDM, Aux Output and Reset features
** Not available for cascading

Accessories

SLC4 Brackets



- SLC4A-MBK-10**
End Mount Bracket
- Rotation: +/- 20°
 - Includes 4 brackets and hardware
 - Glass-filled polycarbonate



- SLC4A-MBK-11**
End Mount Bracket
- Rotation: Fixed
 - Includes 4 brackets and hardware
 - Glass-filled polycarbonate



- SLC4A-MBK-12**
Side mount bracket
- Rotation: +/- 15°
 - Includes 2 brackets
 - Glass-filled polycarbonate

LP Basic & LP Brackets



- LPA-MBK-10**
End mount bracket
- Rotation: 40°
 - Includes 2 brackets and hardware
 - 8 ga. steel, black zinc-plated



- LPA-MBK-16**
Side mount bracket
- Rotation: +15° and -20°
 - Includes 1 bracket and hardware
 - Black zinc die-cast



- LPA-MBK-11**
Standard end mount bracket
- Rotation: 360 Degrees
 - Includes 2 brackets and hardware
 - 14 ga. steel, black zinc-plated
- Not included with LP Basic models



- LPA-MBK-12**
Standard side mount bracket
- Rotation: +10° and -30°
 - Includes 1 bracket and hardware
 - 14 ga. steel, black zinc-plated
- Not included with LP Basic models

LP Brackets for Cascade



- LPA-MBK-21**
Pivoting cascade mounting bracket
- Includes 2 brackets and hardware
 - 14 ga. steel, black zinc-plated

Visit our website for additional bracket options and more details about the listed brackets

Interface Options

Safety Controllers



- XS26-2**
XS26-2d
XS26-2e
XS26-2de
- Expandable safety controller supports up to eight I/O modules and programs easily using icon-based software



- SC26-2**
SC26-2d
SC26-2e
SC26-2de
- Flexible, efficient safety controller has small footprint and programs easily using icon-based software

Safety Modules



- UM-FA-9A**
UM-FA-11A
- Monitors solid-state PNP OSSD safety outputs and provides latching (manual reset) function for applications requiring a reset



- IM-T-9A**
IM-T-11A
- Interface Modules provide isolated safety output contacts for a solid-state output (OSSD) device. It requires monitoring with the External Device Monitoring (EDM) function



- MMD-TA-11B**
MMD-TA-12B
- Muting modules suspend safeguarding during non-hazardous portion of the machine cycle

8-Pin Connections



RD Cordsets

RDLP-815D 4.6 m (15.1')	RDLP-875 23 m (75.5')
RDLP-825D 8 m (26.2')	RDLP-8100 30.5 m (100.1')
RDLP-850D 15.3 m (50.2')	



8-Pin M12/ Euro-Style

QDE-815D 4.5 m (15')	QDE-875D 22.8 m (75')
QDE-825D 7.6 m (25')	QDE-8100D 30.4 m (100')
QDE-850D 15.2 m (50')	



8-Pin Male M12 to Dual 8-Pin Female M12 Euro-Style Splitter

CSB-M1280M1280 No trunk/ no branches	DEE2R-81D 0.3 m (1')	DEE2R-830D 9.1 m (30')
CSB-M1281M1281 0.3 m (1') trunk/2 x 0.3 m (1') branches	DEE2R-83D 0.9 m (3')	DEE2R-850D 15.2 m (50')
CSB-M1288M1281 2.44 m (8') trunk/2 x 0.3 m (1') branches	DEE2R-88D 2.5 m (8')	DEE2R-875D 22.9 m (75')
CSB-M12815M1281 4.57 m (15') trunk/2 x 0.3 m (1') branches	DEE2R-812D 3.6 m (12')	DEE2R-8100D 30.5 m (100')
CSB-M12825M1281 7.62 m (25') trunk/2 x 0.3 m (1') branches	DEE2R-815D 4.6 m (15')	
	DEE2R-825D 7.6 m (25')	

5-Pin Connections



5-Pin M12/ Euro-Style

QDE-515D 4.5 m (15')	QDE-575D 22.8 m (75')
QDE-525D 7.6 m (25')	QDE-5100D 30.4 m (100')
QDE-550D 15.2 m (50')	



5-Pin Male M12 to Dual 5-Pin Female M12 Euro-Style Splitter

CSB-M1250M1250 No trunk/ no branches	DEE2R-51D 0.3 m (1')	DEE2R-530D 9.1 m (30')
CSB-M1251M1251 0.3 m (1') trunk/2 x 0.3 m (1') branches	DEE2R-53D 0.9 m (3')	DEE2R-550D 15.2 m (50')
CSB-M1258M1251 2.44 m (8') trunk/2 x 0.3 m (1') branches	DEE2R-58D 2.5 m (8')	DEE2R-575D 22.9 m (75')
CSB-M12515M1251 4.57 m (15') trunk/2 x 0.3 m (1') branches	DEE2R-512D 3.6 m (12')	DEE2R-5100D 30.5 m (100')
CSB-M12525M1251 7.62 m (25') trunk/2 x 0.3 m (1') branches	DEE2R-515D 4.6 m (15')	
	DEE2R-525D 7.6 m (25')	

Cascade Connections

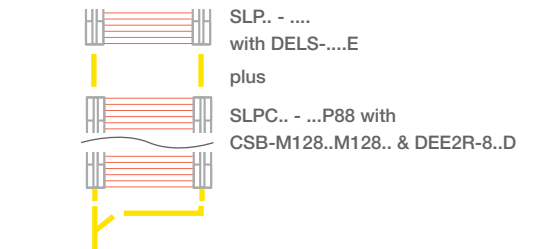
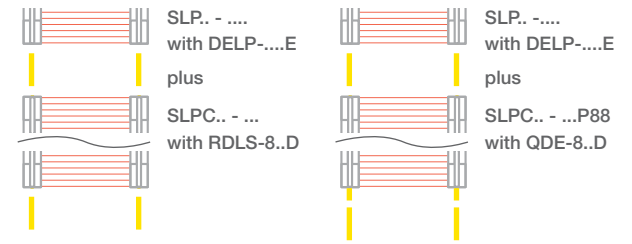

Double-Ended RD to RD Cordsets

DELP-110E 0.05 m (0.2')	DELP-118E 2.5 m (8.2')	DELP-1150E 15.3 m (50.2')
DELP-111E 0.3 m (1')	DELP-1115E 4.6 m (15.1')	DELP-1175E 23 m (75.5')
DELP-113E 1 m (3.3')	DELP-1125E 8 m (26.2')	DELP-11100E 30.5 m (100.1 Dave's')

Alignment Aids for LP and LP Basic



Model	Description	Model	Description
LAT-1-LP	Self-contained visible-beam laser tool for aligning any LP emitter/receiver pair. Includes Laser, LAT Mounting Clip, Reflective Target Material	LPA-LAT-1	Clip On Target for LAT Includes Reflective Target and LAT Mounting Clip
		LPA-LAT-2	Replacement clip for attaching LAT and Reflector



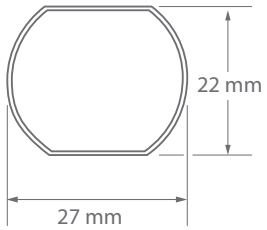

Specifications

SLC4

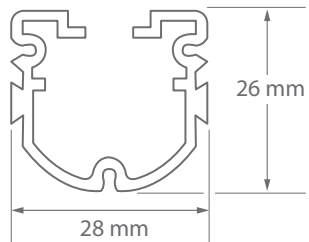

LP and LP Basic



Operating Range	SLC4: 0.1 to 2 m (4 in to 6.5 ft) LP Basic: 0.1 to 4 m (4 in to 13 ft) LP: 0.1 m to 7 m (4 in to 23 ft)	Supply Voltage at the Device	24 V dc \pm 15% (use a SELV-rated power supply according to EN IEC 60950)
Resolution	SLC4: 14 mm or 24 mm, depending on model LP Basic, LP: 14 mm or 25 mm, depending on model	Short Circuit Protection	All inputs and outputs are protected from short circuits to +24 V dc or dc common
Output	SLC4: Two redundant solid-state outputs (OSSD) 24 V dc, 0.3 A max. per OSSD LP Basic, LP: Two redundant solid-state outputs (OSSD) 24 V dc, 0.5 A max. per OSSD	Electrical Safety Class	III (per IEC 61140: 1997)
Environmental Rating	SLC4, LP: IEC IP65 LP Basic: IEC IP54	Safety Rating	Type 4 per IEC 61496-1, -2 Category 4 PL e per EN ISO13849-1 SIL3 per IEC 61508; SIL CL3 per IEC 62061
Operating Conditions	SLC4: -20 to +55 °C (-4 to +131 °F) LP Basic, LP: 0 to +55 °C (+32 to +131 °F) 95% maximum relative humidity (non-condensing)	Dimensions (mm)	SLC4: 26.7 W x 22.1 D LP and LP Basic: 26 W x 28 D Height varies by model
		Certifications	SLC4:   LP Basic, LP:  

Banner offers intuitive, easy-to-use safety light screens for a wide variety of safety applications



HEAVY-DUTY TYPE 4

Robust safety light curtains for harsh industrial environments.

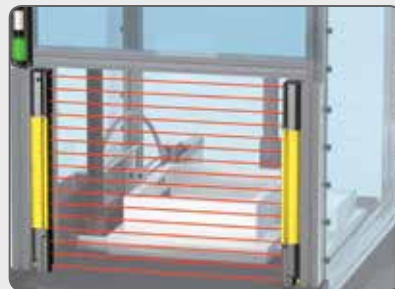

COMPACT TYPE 4

Compact safety light curtains for safety in tight spaces.



PERIMETER GUARDING TYPE 4

One to four beam safety light devices.

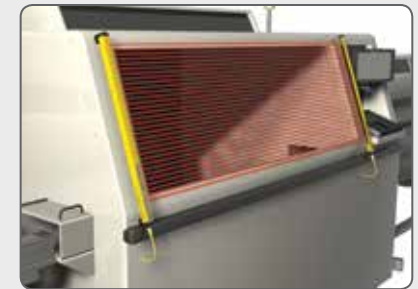

TYPE 2

Cost-effective safety light curtain for lower risk applications.



PN 205109 rev. B

© 2019 Banner Engineering Corp. Minneapolis, MN USA

1-888-373-6767

www.bannerengineering.com

BANNER[®]
more sensors, more solutions